



ASSOCIATION FOR WOMEN
IN THE SCIENCES • 2017

13–14 JULY 2017

HERITAGE HOTEL AUCKLAND







ASSOCIATION FOR WOMEN
IN THE SCIENCES • 2017

HAERE MAI | WELCOME

We hope you enjoy #AWIS2017
Don't forget to follow us on Facebook and Twitter @awisnz

AWIS2017 Organising Committee:

Emma Timewell

Ashleigh Fox

Miriam Hall

Nicolette Rattenbury

PROGRAMME DAY 1: 13 JULY 2017

8.30 AM REGISTRATION OPENS

9.30 AM MORNING TEA

10.00 AM OPENING SESSION

Welcome and housekeeping

Emma Timewell, AWIS

Keynote

In a recent national survey, women shared their thoughts about their careers, what they aspire to next, and what helps and hinders their progress – at work and beyond. This session present some of the key findings from this unique NZ study, and discuss their policy and practical implications.

Jane Parker, Massey University
Nazim Taskin, Massey University

11.00 AM CONCURRENT STREAMS

Looking into the past
Room: Robert Laidlaw

Curiosity about where we have all come from keeps us exploring the distant past – studying societies, excavating settlements and even analysing genetics. Our speakers talk about what we have discovered, what we can do to find out more, and what it might mean.

Louise Furey, Auckland Museum
Ruth Barton, University of Auckland
Lara Shepherd, Te Papa
Fiona Petchey, Waikato University

Museums
Room: Peter Healey 1

Museums have long been a favourite with adults and children alike. Our speakers will outline some of the initiatives they have been involved with to appeal to a new audience.

Steven Fox, MOTAT
Willow van As, The Bone Lady
Heidi Schlumpf, Auckland Museum

Work life balance
Room: World Champions
Team Room

Work life balance is one of the hardest things to achieve in this fast paced world. Come listen to three women who had had success (and possibly failure) at achieving balance in their lives.

Elaine Rush, AUT
Claire Postlethwaite,
University of Auckland
Jill Stanley, Plant & Food Research

12.30 PM LUNCH

1.30 PM CONCURRENT STREAMS

Behaviour and cognition
Room: Robert Laidlaw

Whether we observe humans, birds or animals, individuals communicate and interact in strange and wonderful ways. Our speakers study a range of species and try to understand their behaviour, as well as what happens when things don't work the way they should.

Kristal Cain, University of Auckland
Alison Wade, University of Auckland
Andrea Kwakowsky,
University of Auckland

<p><i>Curious Minds and citizen science</i> Room: Peter Healey 1</p>	<p>Having a scientifically literate society is essential for our country. Our speakers will talk about various programmes they are involved with that engage children and non-scientists with science.</p>	<p>Sarah Morgan, SouthSci Ashleigh Fox, Family Science Workshops Chris Duggan, House of Science</p>
<p><i>Mentoring</i> Room: World Champions Team Room</p>	<p>Mentoring and coaching can be key factors in achieving a successful and meaningful career. Our speakers come for a variety of roles and will share tools and experiences in feedforward coaching, mentoring and being a mentee that will add to your developmental toolbox.</p>	<p>Mark McSherry, Plant & Food Research Kim Dirks, University of Auckland Sarah Trotman, AUT</p>

3.00 PM AFTERNOON TEA

3.30 PM AFTERNOON SESSION SPONSORED BY MACDIARMID INSTITUTE

<p><i>From the beginning to the future</i> Room: Robert Laidlaw</p>	<p>We will explore the reasons behind AWIS' creation, how the situation for and role of women in science has changed over the past 30 years, and how future women in science view the current landscape and the changes they'd like to see.</p>	<p>Cather Simpson, Chair: Jean Fleming Alexia Hillbertidou, Girl Boss</p>
---	---	---

4.30 PM CELEBRATION

<p><i>Presentation of the Miriam Dell Award</i></p>	<p>We start an evening of celebration with the presentation of the 2015 Miriam Dell Award.</p>	<p>Emma Timewell, AWIS Ros Kemp, Miriam Dell Awardee 2015</p>
---	--	---

5.00 PM DRINKS

6.10 PM WALKING BUS LEAVES

6.30 PM DINNER Grasshopper, Stamford Plaza, 22 Lower Albert St

Please see **page 6** for a map of the room layout.

Please see **page 7** for a map showing the route to Grasshopper.

PROGRAMME DAY 2: 14 JULY 2017

8.30 AM CONCURRENT STREAMS

<i>Computer power</i> Room: Robert Laidlaw	Advances in technology and sheer computing power mean that we are able to achieve so much more now in a variety of applications. We can gather more data, make more interpretations, and reach more people. Our speakers give us snapshots of how they use computer technology to enhance capability in their own fields.	Catherine McGovern, ESR Alys Clark, University of Auckland Barbara Bollard-Breen, AUT
<i>Dealing with the media</i> Room: Peter Healey 1	The media regularly gets a bad rap but scientists don't always do themselves any favours when they deal with them. Between them our speakers will tell both sides of the story.	Peter Griffin, Science Media Centre Rebekah White, NZ Geographic Chlöe Swarbrick, Green Party
<i>Writing research proposals</i> Room: World Champions Team Room	Share experiences and pick up tips, tricks and new tools to help improve your chances of securing research funding and delivering impact for New Zealand.	Marie Bradley, AgResearch Tracy Williams, Plant & Food Research

10.00 AM MORNING TEA

10.30 AM PANEL SESSION

<i>What are the issues for Women in Science?</i> Room: Robert Laidlaw	The panel and open discussion will explore the main issues for the future for women generally, and women in science more specifically, as well as ideas on how these might be addressed.	CHAIR: Kate Hannah Natasha Lewis, Ministry of Women Danielle Newton, UNESCO Siouxie Wiles, Royal Society of NZ
--	--	---

12.30 PM LUNCH

1.30 PM CONCURRENT STREAMS

Rockets, robots and awesomeness
Room: Robert Laidlaw

The future is full of exciting developments, from medical advances to space exploration. Our speakers give us an insight into their respective fields and where we may be heading with all this new technology and knowledge.

Nada Signal, AUT
Joe O'Callaghan, NIWA
Jennie McCormick, Farm Cove Observatory

Creating change
Room: Peter Healey 1

Changing anything within a large organisation can be time consuming and painful. Our speakers will talk about institutional change they have been involved with and how they overcame the inertia to get things changed.

Katie Foote, University of Auckland
Lara Romsdal, University of Auckland
Kate Hannah, Te Pūnaha Matatini

Communications skills
Room: World Champions Team Room

Want to be an effective communicator? This interactive session will start you on your way to communicating your science with a range of audiences.

Emma Timewell, Plant & Food Research

3.00 PM AFTERNOON TEA

3.15 PM CLOSING SESSION

We will include the AWIS AGM for 2017 before we round up the conference.

Emma Timewell, National Convenor
Hazel Gatehouse, Treasurer

CLOSE

ROOM MAP: HERITAGE HOTEL

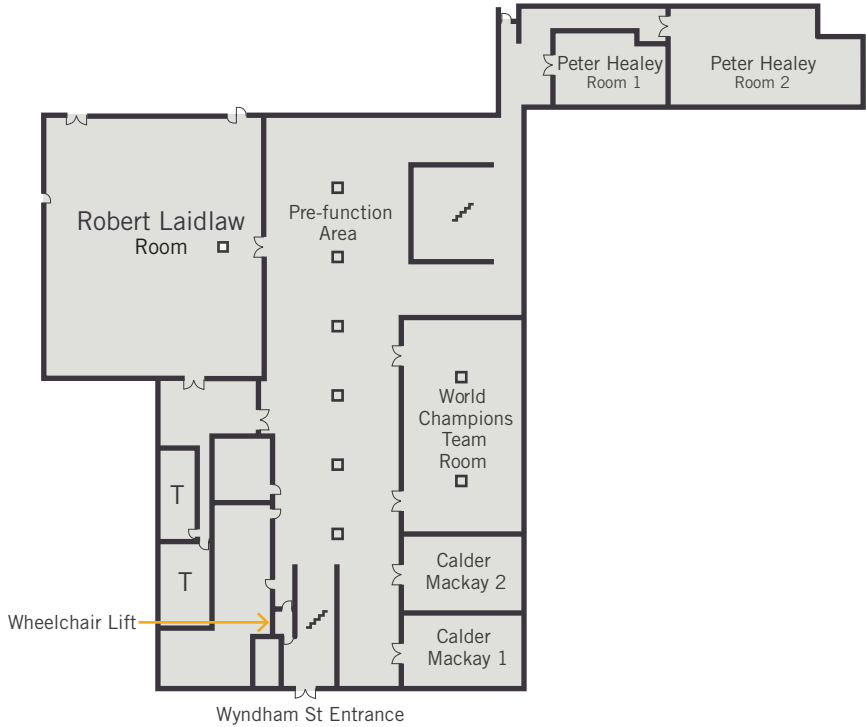

ROUTE MAP: TO DINNER VENUE

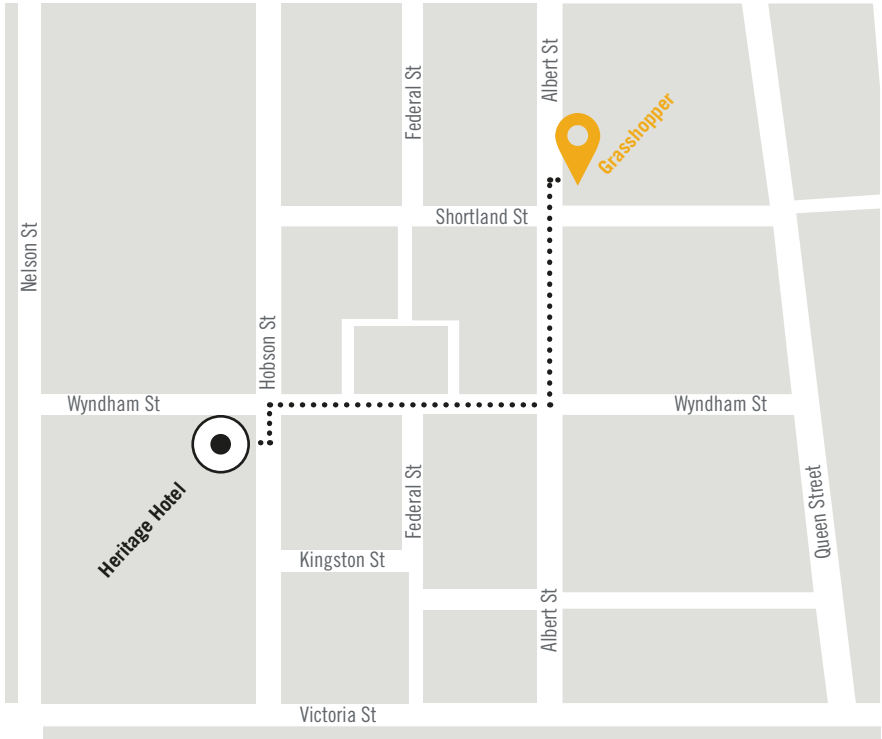

THANK YOU TO OUR SPONSORS

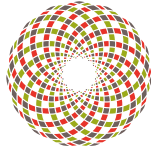

Te Pūnaha Matatini
Data ■ Knowledge ■ Insight



**CURIOUS
MINDS**
HE HIHIRI I TE MAHARA



**MINISTRY OF BUSINESS,
INNOVATION & EMPLOYMENT**
HĪKINA WHAKATUTUKI



**Plant & Food
RESEARCH**
RANGAHAU AHUMĀRA KAI



NIWA
Taihoro Nukurangi



THE UNIVERSITY OF
AUCKLAND
Te Whare Wānanga o Tāmaki Makaurau
NEW ZEALAND

SCIENCE



United Nations
Educational, Scientific and
Cultural Organization

**New Zealand National
Commission for UNESCO**

Te Kōwhiri Mātua o Aotearoa mō UNESCO



The MacDiarmid Institute
for Advanced Materials and Nanotechnology



DODD-WALLS CENTRE
for Photonic and Quantum Technologies



CAWTHON
The power of science®



MAURICE WILKINS CENTRE
FOR MOLECULAR BIODISCOVERY

